

Please read the following instructions before operating your sharpener.



● **To be used under adult supervision only.**

Model	Product Code	Replacement Blade Code	Compatible Pencil Size(s)
Sketch	40050	40805	8mm

- 1 Press machine down firmly on a stable, flat surface to activate suction feet.
- 2 Check the shavings drawer is correctly fitted.
- 3 Connect the electricity plug to a standard power socket.
- 4 Gently insert pencil horizontally into pencil opening
- 5 Sharpening will start automatically
- 6 Keep pencil straight to avoid uneven sharpening
- 7 Once the pencil has its desired point, the machine will automatically stop sharpening
- 8 Remove the pencil from the pencil opening to deactivate the machine

Cleaning

Regular cleaning will ensure that your sharpener operates efficiently.

- Use a small brush (e.g. paintbrush or toothbrush) to clean the cutting blade. Never use metal objects as this may damage the cutting blade.
- The shavings tray can be removed and cleaned with water only. Never clean the main sharpener unit with water or use solvents such as alcohol or thinner.

Coloured Pencils

- Sharpening coloured pencils causes wax to build up on the sharpener blade.
- We recommend alternating between coloured and graphite pencils as graphite will help to clean the blade.
- If excessive build up occurs then clean the blade as per the instructions above.

Sketch Electric Pencil Sharpener Operating Instructions

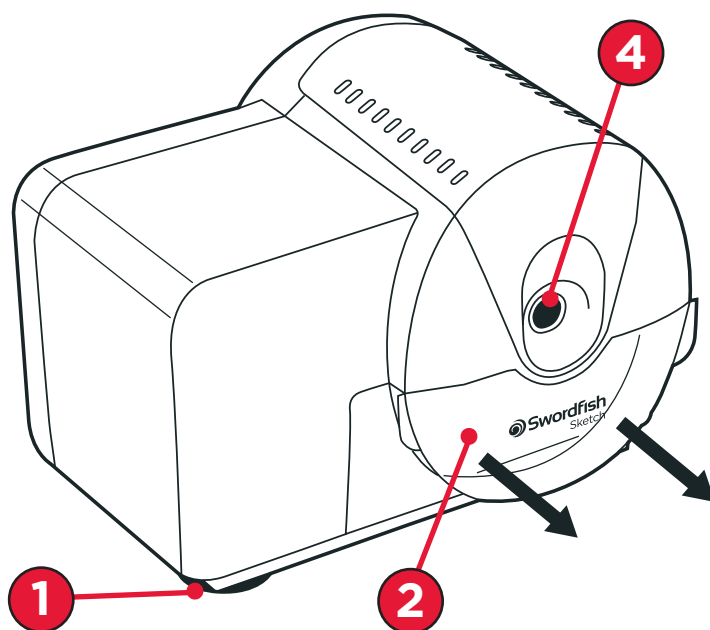

Safety Switch

- This sharpener is fitted with a safety switch ensuring that it cannot be operated unless the shavings tray is fully in place.

Thermal cut-out system

- This sharpener is suitable for intermittent use and should not be used continuously for more than 12 minutes. Continual use will cause the thermal cut-out system to activate. This is a safety feature and the sharpener will require a cool down period of approx. 20-30 minutes before it is ready for use.

Replacement Blades

- As with all sharpeners, frequent use will eventually blunt the sharpener blade. For replacement blades, please contact your supplier quoting product code **40805**.